



Automobile water temperature sensors,chip

Product No.: NSC*

Automotive internal temperature sensor is the water temperature sensor, the lower temperature is, the greater the resistance; The smaller the vice resistance, installed in the engine cylinder or cylinder head water jacket, direct contact with cooling water. Which side of the engine cooling water temperature.

汽车水温传感器的内部是汽车水温传感器，温度愈低，电阻愈大；反之电阻愈小，安装在发动机缸体或缸盖的水套上，与冷却水直接接触。从而测得发动机冷却水的温度。

Features:

- ◆ No lead
- ◆ High sensitivity
- ◆ High compatibility and stability
- ◆ Operation temperature range $-40 \sim +125^{\circ}\text{C}$
- ◆ Resistance tolerance: $\pm 3\%, \pm 5\%, \pm 10\%, \pm 15\%, \pm 20\%$

Applications:

- ◆ widely used in automobile, shipping, armored car, combustion engines, oiliness transformer.

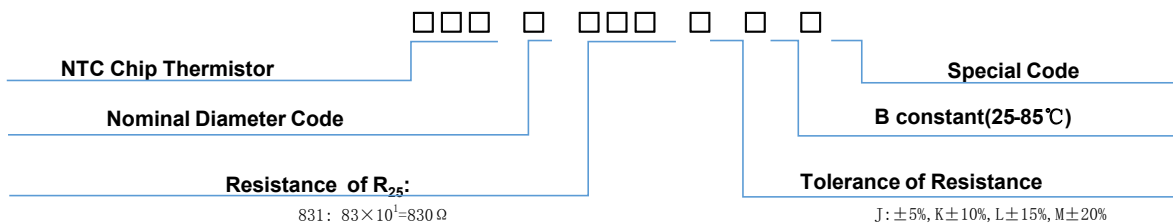

SHAPE & DIMENSIONS

Part No.	D ±0.3	T ±0.2	Nominal Resistance at 25°C	Beta Value ±3%, ±5%
	(mm)	(mm)	(Ω)	(K, 25/85°C)
NSCA*	4.9	1.3	880	3600
NSCB*	7.5	1.6	340	3600
NSCC*	5.6	1.5	845	3500
NSCD*	7.2	1.5	570	4000
NSCE*	6.7	1.5	2500	4100
NSCF*	6.5	1.5	2320	4100
NSCG*	5.6	1.5	2420	4150
NSCH*	6.5	1.5	1180	4200
NSCI*	7.3	1.5	420	4200
NSCJ*	5	1.2	820	4200
NSCK*	4.9	1.2	480	4200
NSCL*	5.6	1.3	3200	4200
NSCM*	5	1.4	685	4200
NSCN*	9	1.7	470	4250

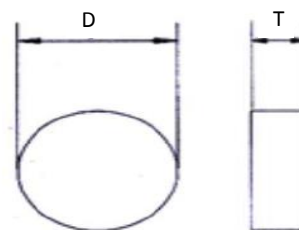
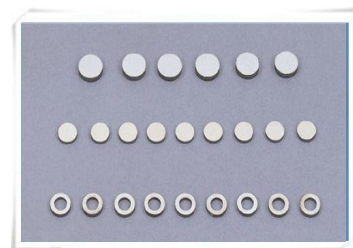



R-T characteristic

Temp. °C	NSCA	NSCB	NSCC	NSCD	NSCE	NSCF	NSCG
-40	25490	9850	22294	24002	126922	107270	114540
-30	12000±10%	5220	12024	11853	60504	52046	55328
-20	6800±14%	2908	6810	6189	30581	26737	28308
-10	4385	1694	4027	3395	16279	14448	15240
0	2700±10%	1027	2474	1946	9076	8168	8585
10	1668	645	1574	1160	5273	4807	5036
20	1080±10%	418	1032	717	3179	2933	3064
25	880	340	845	570	2500	2320	2420
30	720	279	696	457	1982	1849	1926
40	495	191	482	300	1273	1201	1247
50	345	134	341	200±15%	841	801	830
60	247	96	246	139	535±12%	547	566
70	180	70	181	98	394	382	394
80	134	52	136	71	275±16%	273	281
85	116	45	118	60±5%	236	232	238
100	77±6%	30	80	38	140±14%	146	150
107	65	25	67	32±6%	120	119	122
120	48	18	50	22±9%	83	84	85

Temp. °C	NSCH	NSCI	NSCJ	NSCK	NSCL	NSCM	NSCN
-40	59907	21323	41631	24369	162461	34777	25003
-30	28558	10165	19845	11617	77445	16578	11815
-20	14434	5138	10031	5872	39144	8379	5923
-10	7684	2735	5340	3126	20838	4461	3130
0	4284	1525	2977	1743	11617	2487	1733
10	2489	886	1729	1012	6749	1445	1000
20	1500	534	1043	610	4069	871	599
25	1180	420	820	480	3200	685	470
30	935	333	650	380	2537	543	372
40	601	214	418	244	1630	349	237
50	397	141	276	161	1076	230	156
60	269	96	187	109	728	156	105
70	186	66	129	76	505	108	72
80	132	47	91	54	357	76	51
85	111	40	77	45	302	65	43
100	70	25	48	28	189	40	27
107	57	20	39	23	153	33	22
120	39	14	27	16	106	23	15

Note: Resistance range no marking tolerance is ±10%.